

2.1 Male Connector

02. Metric Tube x NPT (M)

Material - **SS 304 | SS 316**

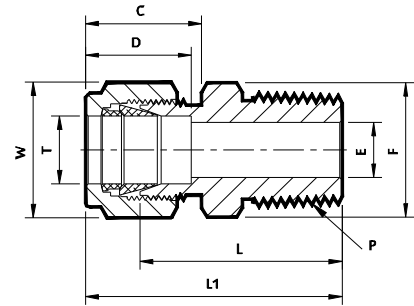
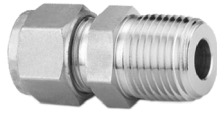

Sr. No.	TUBE OD Ø T	NPT Male Pipe Size	Ref. Part No.		ØE	D	C	L	L1	Body Hex F	Nut Hex W
			SS 304	SS 316							
	(mm)	(In)	MMCD4	MMCD6			Dimensions in Millimetres				
1	6 x 1/8		6MMCD2Nx4	6MMCD2Nx6	4.8	15.3	17.7	25.4	32.8	14.2	14.2
2	6 x 1/4		6MMCD4Nx4	6MMCD4Nx6	4.8			30.5	37.9	14.2	
3	6 x 3/8		6MMCD6Nx4	6MMCD6Nx6	4.8			31.0	38.4	17.4	
4	6 x 1/2		6MMCD8Nx4	6MMCD8Nx6	4.8			37.3	44.7	22.2	
5	8 x 1/8		8MMCD2Nx4	8MMCD2Nx6	4.8	16.2	18.6	26.7	34.2	16	16
6	8 x 1/4		8MMCD4Nx4	8MMCD4Nx6	6.4			31.2	38.7	16	
7	8 x 3/8		8MMCD6Nx4	8MMCD6Nx6	6.4			31.8	39.3	17.4	
8	8 x 1/2		8MMCD8Nx4	8MMCD8Nx6	6.4			38.1	45.6	22.2	
9	10 x 1/8		10MMCD2Nx4	10MMCD2Nx6	4.8	17.2	19.5	28.7	36.3	19	19
10	10 x 1/4		10MMCD4Nx4	10MMCD4Nx6	7.9			33.3	40.9	19	
11	10 x 3/8		10MMCD6Nx4	10MMCD6Nx6	7.9			33.3	40.9	19	
12	10 x 1/2		10MMCD8Nx4	10MMCD8Nx6	7.9			38.9	46.5	22.2	
13	12 x 1/8		12MMCD2Nx4	12MMCD2Nx6	4.8	22.8	22.0	28.7	38.8	22.2	22.2
14	12 x 1/4		12MMCD4Nx4	12MMCD4Nx6	7.1			33.3	43.4	22.2	
15	12 x 3/8		12MMCD6Nx4	12MMCD6Nx6	9.5			33.3	43.4	22.2	
16	12 x 1/2		12MMCD8Nx4	12MMCD8Nx6	9.5			38.9	49.0	22.2	
17	12 x 3/4		12MMCD12Nx4	12MMCD12Nx6	9.5		40.4	50.5	27		
18	15 x 1/2		15MMCD8Nx4	15MMCD8Nx6	11.9	24.4	22.0	38.9	49.0	25.4	25.4
19	16 x 3/8		16MMCD6Nx4	16MMCD6Nx6	9.5	24.4	22.0	34.0	44.1	25.4	25.4
20	16 x 1/2		16MMCD8Nx4	16MMCD8Nx6	11.9			38.9	49.0	25.4	
21	16 x 3/4		16MMCD12Nx4	16MMCD12Nx6	12.7			40.4	50.5	25.4	
22	18 x 1/2		18MMCD8Nx4	18MMCD8Nx6	11.9			40.4	50.5	27	
23	18 x 3/4		18MMCD12Nx4	18MMCD12Nx6	15.1	24.4	22.0	40.4	50.5	27	30
24	20 x 1/2		20MMCD8Nx4	20MMCD8Nx6	11.9	26.0	22.0	42.2	52.3	30	32
25	20 x 3/4		20MMCD12Nx4	20MMCD12Nx6	15.9			42.2	52.3	30	
26	20 x 1		20MMCD16Nx4	20MMCD16Nx6	21.8			47.1	57.7	35	
27	25 x 1/2		25MMCD8Nx4	25MMCD8Nx6	11.9			45.2	57.5	35	
28	25 x 3/4		25MMCD12Nx4	25MMCD12Nx6	15.9	31.3	26.5	45.2	57.5	35	38
29	25 x 1		25MMCD16Nx4	25MMCD16Nx6	21.8			50.0	62.3	35	

- NOTE :
- ① The E Dimension is the minimum opening & Fittings of this group may be back drilling to lager ID at pipe thread or straight thread end
 - ② Dimension L1, C, D is shown in the finger-tight position.
 - ③ NPT thread as per ANSI B 1.20.1.